

KWC AVA 2.0  
Trim kit - Lever mixer - Basin

Modell-Linie: AVA 2.0 | 11.462.033.000 ++  
Taps | Manual taps

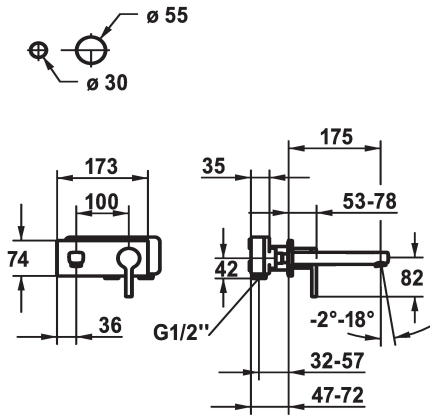

KWC-No.

11.462.033.000  
all chrome, A 175, Trim kit

11.462.034.000  
all chrome, A 225, Trim kit

spout projection

175 mm

225 mm

- Fixed spout
  - Neoperl® Perlator® SSR, swivelling jet regulator
- OptimalSpace - ample space for washing or working
- KWC cartridge M 35 H
  - with ceramic discs
  - flow rate and temperature continuously variable

- To be ordered separately:
  - Unit for concealed installation ½" 39.001.402.000
- To be ordered separately (optional or if necessary):
  - Extension set 20 mm Z.536.333
- Flow rate 5 l/min (3 bar)  
Acoustic group I

Technical Data

spout projection

175 mm

